

SUPERTOOTH 3

BLUETOOTH HANDSFREE

Quick Start Guide

1 First Time Turn ON and Pairing

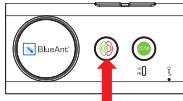

Press the **MFB** until the LED blinks **red/blue**.

2

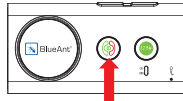

Confirm language selection by pressing the **MFB** as soon as your language is spoken on the **SUPERTOOTH 3**.

3

The **SUPERTOOTH 3** will then ask you to pair your phone.



On your phone bluetooth menu, search for devices and select **BlueAnt ST3** then enter **0000** as pincode.

4A

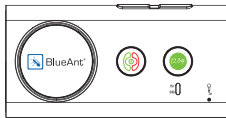

Phonebook transfer will be initiated. Accept any connection request on your phone if prompted. Then wait until **SUPERTOOTH 3** says: "**BlueAnt ST3 ready, connected to phone.**"

4B

In case your phone doesn't support automatic transfer (do not press the **HOTKEY** on your **SUPERTOOTH 3**), go to your phones "**Contact Menu**", then select:

- 1) **OPTION**
- 2) **Mark all**
- 3) **Option** } *if available*
- 4) **Send or Send Business card**
- 5) **Via Bluetooth**
- 6) **Select BlueAnt ST3**

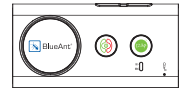

Note: Blackberry and Smart phone owners please refer to section F of user guide.

5A

Activation of Voice Answer:

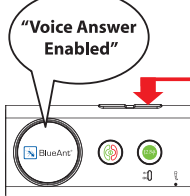

Press **VOL +** for 5 seconds until the **SUPERTOOTH 3** confirms this mode.

5B

Deactivation of Voice Answer:

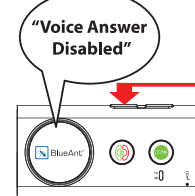

Press **VOL -** for 5 seconds until the **SUPERTOOTH 3** confirms this mode.

NOTE: Voice activation or deactivation is possible only if you're not on call.

6

Manual Answer

Press the **MFB** to answer incoming call.

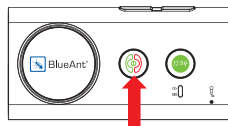

7

End / Reject Call

Press the **MFB** to end a call or long press to reject a call.

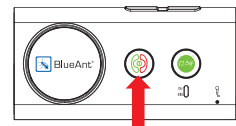

8

Voice Answer (if option is activated)

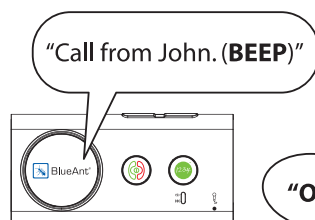

After the BEEP, say clearly one of the words below:

- "ACCEPT CALL"
- "ACCEPT"
- "ANSWER"
- "OK"

IMPORTANT: Voice answer will not work if you don't wait for the **BEEP**.



BlueAnt®

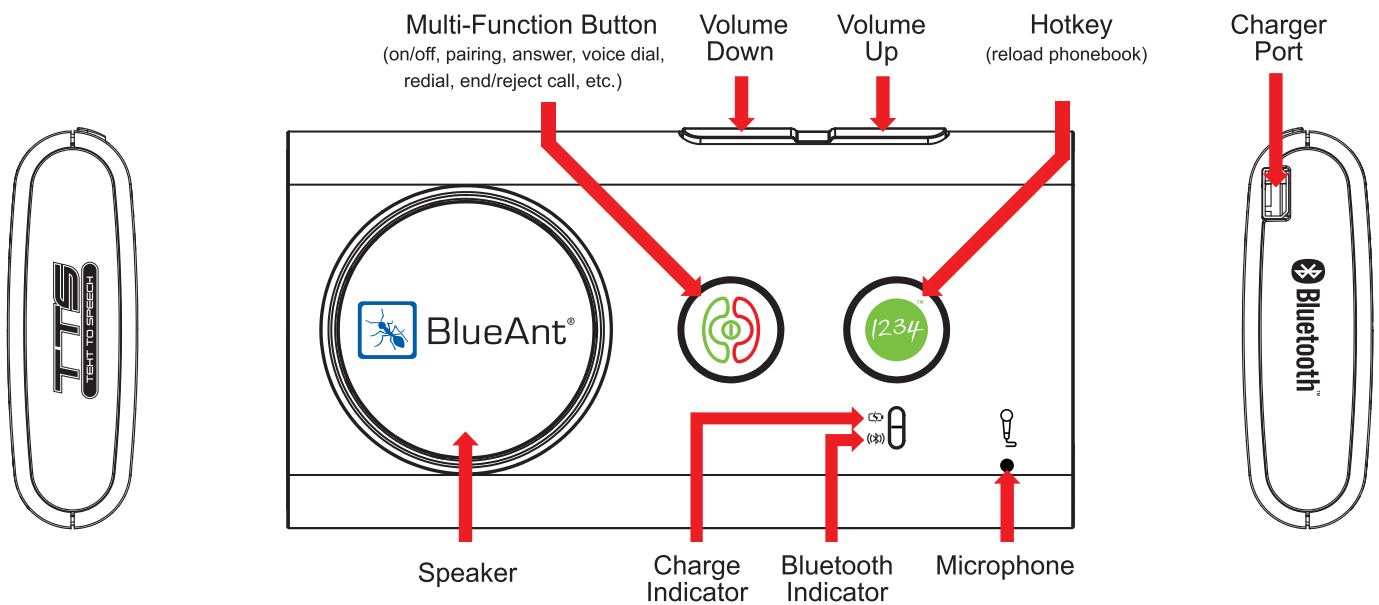

Installation

Fix the metal clip of the **SUPERTOOTH 3** to the sun-visor

Attach the magnetic back of the **SUPERTOOTH 3** to the fixed metal clip

The **SUPERTOOTH 3** must be placed in such a way that its microphone is directed to the mouth of the user.

Other Functions

Turn ON

Press the **MFB** for 1 second to turn ON.

Turn OFF

Press **MFB** until "**SUPERTOOTH 3 Powering Down**" is announced.

Volume

Press repeatedly **VOL +** or **VOL -** to adjust the volume.

Hotkey

Press the **HOTKEY** to get operator assistance.

Calls to 1234 are charged a fee of \$1.40. A fee of \$0.88 will be charged when you are successfully connected to the person or business you need (standard rates will apply to your connected call). If you are calling from a mobile, your mobile rates will also apply. But, if you don't want to be connected you can have most of the information sent by SMS to your mobile phone, this is included in the 1234 call charges.

